

Banding area if needed.

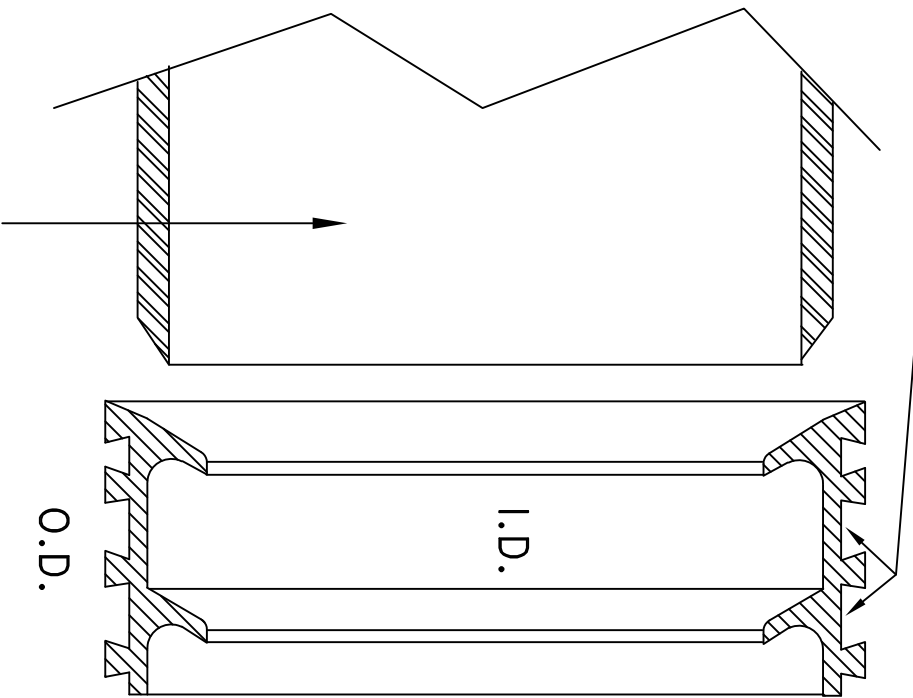

Typical PVC Pipe
Beveled cut—end
ready to receive
Waterstop Gasket.
4”—12” Profile shown.

Manhole cut—out for Pipe inlet. To be grouted around the waterstop.

Structure wall.

ASTM material spec's shown apply to material physical properties only.

Sym	Revisions	Date	By

Clean and bevel pipe before the gasket is stretched onto the OD as shown. If needed, stainless clamps placed in grooves. As pipe is placed into MH wall, center gasket in wall cut—out, support pipe, pack cut—out with proper grout, backfill after it has fully set—up.

Cut—out should be 4” diam. larger than pipe OD.

Typical Installation of the Vertite Waterstop Gasket.



Description

VERTITE W—S, Waterstop

Material

C425, C443, C923, F477, 50±5

Scale	Date	Drawn By	Die Number
Note	12—28—00	WCA	V—0032